



MAS/T

Remote controlled thermostatic mixing valve

The essential and indispensable feature of the mixer is its response speed to temperature variations. The mixer compares the water temperature, measured by the probe, with the value set using the knob on the cap

Depending on the temperature difference detected and the proportional band, the controller processes the data and sends modulating commands to the valve that optimise the speed and stability of the system (PID with exponential-type band).

This allows great stability even at very low consumption flow rates of domestic hot water.

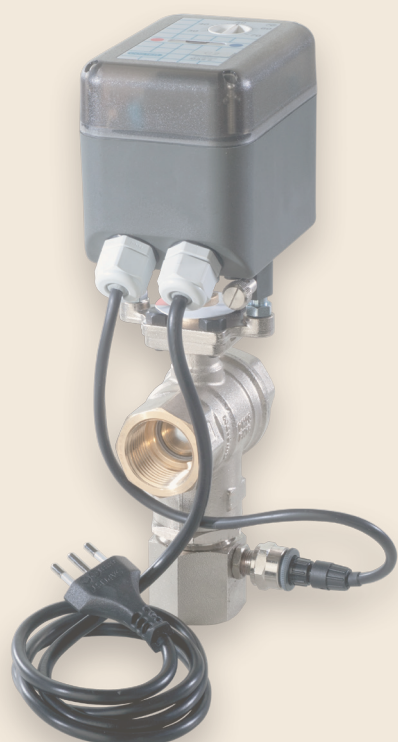

With the remote controlled /T version the electronic mixing valve has been integrated in the system based on the YLC controller.

Communicates with the YLC controllers by Modbus and it can be remote controlled using the GSM 232 modem.

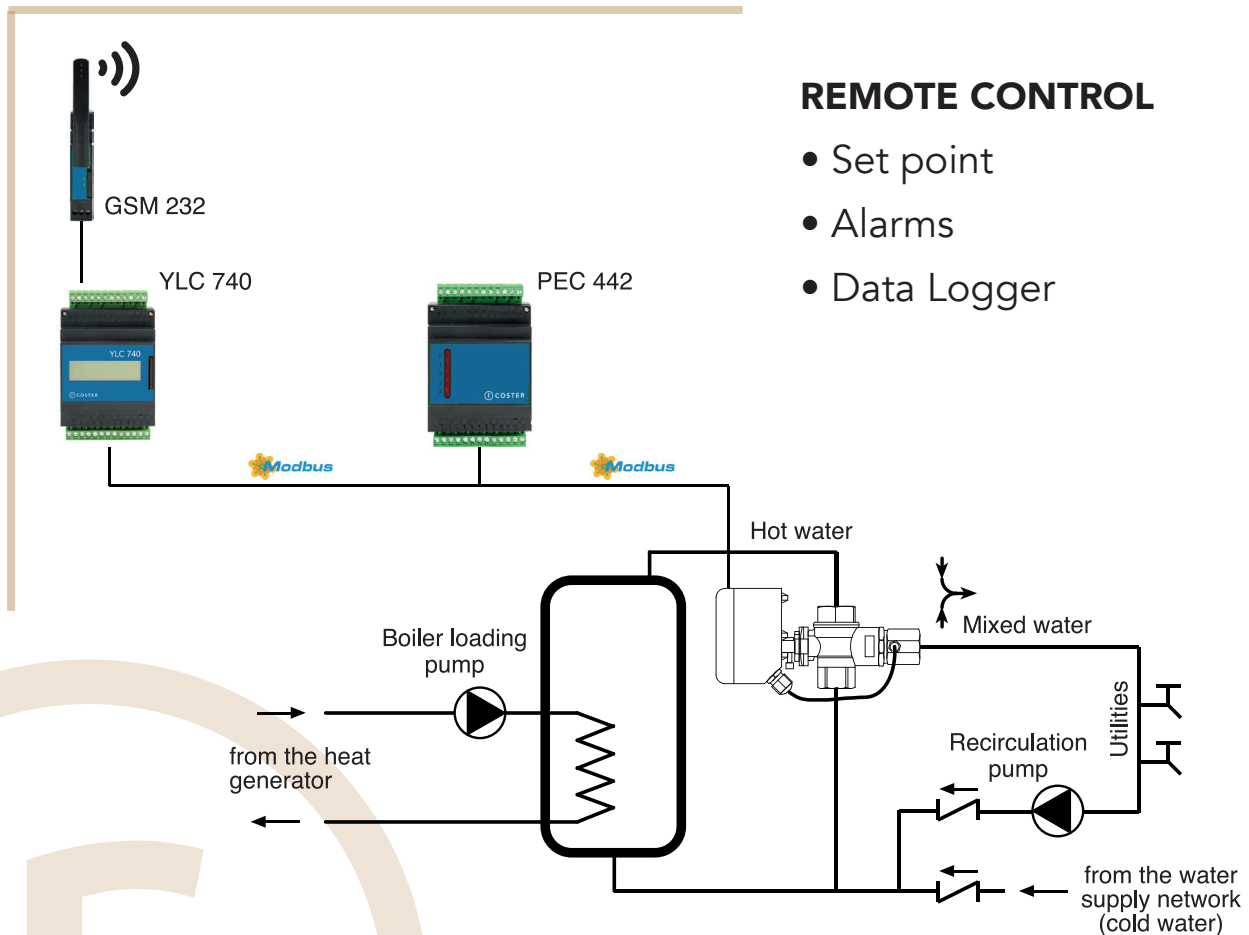

NEUTRALISING LEGIONELLA BACTERIA

The /AL versions also perform the important function that aims to neutralise the legionella bacteria, in all parts of the hydraulic water distribution circuit, where the water itself circulates naturally or through a pump.